

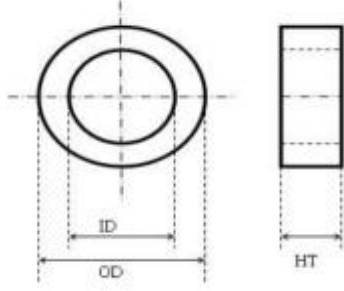

## Nanocrystalline Instrument Current Transformer Core

1. Bare Core Size



2. Finished Size (Core Cap)

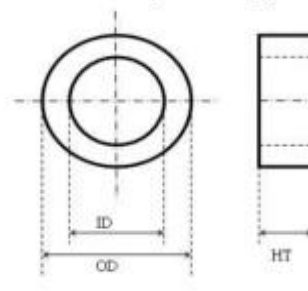

Core Size	Core Caps	Specification					Packing
		I (MA)	55	230	700	7000	
115/95*10	120/90*15	V(MV)	0.32	4.80	11.70	15.00	DMC ( 2 plastic case)
115/95*15	120/90*20	V(MV)	0.48	7.20	17.60	22.50	DMC ( 2 plastic case)
115/95*20	120/90*25	V(MV)	0.64	9.60	23.40	30.00	DMC ( 2 plastic case)
115/95*25	120/90*30	V(MV)	0.80	12.00	29.30	37.50	DMC ( 2 plastic case)
115/95*30	120/90*35	V(MV)	0.96	14.40	35.10	45.00	DMC ( 2 plastic case)
		I (MA)	48	220	660	6600	
120/80*10	125/75*16	V(MV)	0.65	9.50	23.50	29.50	DMC ( 2 plastic case)
120/80*20	125/75*26	V(MV)	1.30	19.00	47.00	59.00	DMC ( 2 plastic case)
		I (MA)	52	230	700	7000	
120/90*10	125/85*17	V(MV)	0.48	7.10	17.50	23.00	DMC ( 2 plastic case)
120/90*15	125/85*22	V(MV)	0.72	10.70	26.30	34.50	DMC ( 2 plastic case)
120/90*20	125/85*26	V(MV)	0.96	14.20	35.00	46.00	DMC ( 2 plastic case)
120/90*25	125/85*31	V(MV)	1.20	17.80	43.80	57.00	DMC ( 2 plastic case)
120/90*30	125/85*36	V(MV)	1.44	21.30	52.50	69.00	DMC ( 2 plastic case)
		I (MA)	52	240	720	7200	
120/95*10	125/90*16	V(MV)	0.40	6.00	14.60	19.00	DMC ( 2 plastic case)
120/95*15	125/90*21	V(MV)	0.60	9.00	21.90	28.50	DMC ( 2 plastic case)
120/95*20	125/90*26	V(MV)	0.80	12.00	29.20	38.00	DMC ( 2 plastic case)
		I (MA)	55	260	770	7700	
125/105*20	100/130*26	V(MV)	0.65	9.5	23.5	30.5	DMC ( 2 plastic case)
		I (MA)	45	210	610	6100	
125/60*55	130/55*62	V(MV)	5.7	85	210	270	DMC ( 2 plastic case)
		I (MA)	52	240	720	7200	
125/90*10	130/85*16	V(MV)	0.55	8.3	20.5	26.5	DMC ( 2 plastic case)
		I (MA)	55	250	760	7600	
140/85*20	145/80*26	V(MV)	1.8	26	65	83	DMC ( 2 plastic case)
		I (MA)	60	280	820	8200	
145/105*10	150/100*17	V(MV)	0.66	9.6	23.5	30.2	DMC ( 2 plastic case)
145/105*15	150/100*22	V(MV)	0.99	14.4	35.3	45.3	DMC ( 2 plastic case)
145/105*20	150/100*27	V(MV)	1.32	19.2	47	60.4	DMC ( 2 plastic case)
145/105*30	150/100*36	V(MV)	1.98	28.8	70.5	90.6	DMC ( 2 plastic case)
		I (MA)	60	280	830	8300	
150/100*10	155/95*15	V(MV)	0.8	11.8	29.5	38	DMC ( 2 plastic case)
150/100*15	155/95*21	V(MV)	1.2	17.7	44.3	57	DMC ( 2 plastic case)
150/100*30	155/95*35	V(MV)	2.4	35.4	88.5	114	DMC ( 2 plastic case)
		I (MA)	60	290	870	8700	
150/110*15	155/105*21.5	V(MV)	0.95	14	35.5	45.5	DMC ( 2 plastic case)
		I (MA)	65	300	900	9000	
150/120*15	155/115*21.5	V(MV)	0.75	10.5	26.5	34	DMC ( 2 plastic case)
		I (MA)	55	270	790	7900	
150/86*10	155/81*16	V(MV)	1	15	37.5	48	DMC ( 2 plastic case)



## Nanocrystalline Instrument Current Transformer Core

1. Bare Core Size

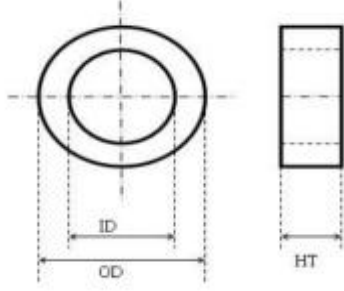

2. Finished Size (Core Cap)

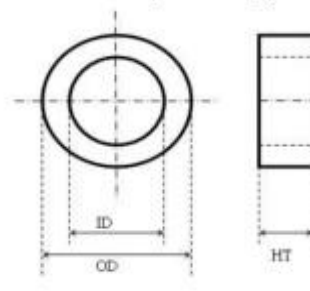

Core Size	Core Caps	Specification					Packing
150/86*20	155/81*21	V(MV)	2	30	75	96	DMC ( 2 plastic case)
		I (MA)	60	280	840	8400	
155/95*20	160/90*26	V(MV)	2.5	26	75	91	DMC ( 2 plastic case)
155/95*50	160/90*56	V(MV)	6.4	65	195	230	DMC ( 2 plastic case)
		I (MA)	70	310	950	9500	
160/125*10	165/120*16	V(MV)	0.56	8	20.6	26.5	DMC ( 2 plastic case)
160/125*15	165*120/21	V(MV)	0.84	12	30.9	39.8	DMC ( 2 plastic case)
160/125*20	165/120*26	V(MV)	1.12	16	41.2	59.7	DMC ( 2 plastic case)
		I (MA)	75	330	1000	10000	
170/130*15	175/125*21	V(MV)	1	14	35	45	DMC+pcb cap
175/125*15	180/120*21	V(MV)	1.2	17.7	44.1	57	DMC+pcb cap
175/125*20	180/120*26	V(MV)	1.6	23.6	58.8	76	DMC+pcb cap
		I (MA)	75	350	1070	10700	
175/145*60	180/140*67	V(MV)	3	42	105	136	Steel Case +PCB Cape
		I (MA)	80	360	1100	11000	
175/155*10	180/150*16	V(MV)	0.35	4.7	11.7	15	Steel Case +PCB Cape
		I (MA)	70	330	990	9900	
180/115*10	185/110*16	V(MV)	1	15.4	38	49	DMC+pcb cap
180/115*15	185/110*21	V(MV)	1.5	23.1	57	73.5	DMC+pcb cap
180/115*20	185/110*26	V(MV)	2	30.8	76	98	DMC+pcb cap
180/115*30	185/110*36	V(MV)	3	46.2	114	147	Steel Case +PCB Cape
		I (MA)	80	350	1070	10700	
180/140*15	185/135*21	V(MV)	0.95	14	35	45	Steel Case +PCB Cape
		I (MA)	90	410	1200	12000	
190/171*10	195*166*16	V(MV)	0.3	4.2	11.2	14.3	DMC+pcb cap
190/171*15	195*166*21	V(MV)	0.45	6.3	16.8	21.5	Steel Case +PCB Cape
190/171*20	195/166*26	V(MV)	0.6	8.4	22.4	28.6	Steel Case +PCB Cape
230/115*15	237/108*21	V(MV)	2.7	40.5	102	130.5	Steel Case +PCB Cape
		I (MA)	90	420	1250	12500	
230/140*50	237/133*56	V(MV)	7	105	265	340	Steel Case +PCB Cape
		I (MA)	100	460	1400	14000	
230/185*20	237/178*26	V(MV)	1.4	21	53	68	Steel Case +PCB Cape
		I (MA)	95	430	1300	13000	
235/155*40	242/148*46	V(MV)	5	75	187	241	Steel Case +PCB Cape
		I (MA)	110	500	1500	15000	
240/200*20	247/193*26	V(MV)	1.3	19	47	61	Steel Case +PCB Cape
		I (MA)	110	500	1500	15000	
240/205*10	247/198*16	V(MV)	0.55	8.3	20.5	26.5	Steel Case +PCB Cape
		I (MA)	110	500	1500	15000	
245/220*40	252/213*46	V(MV)	1.6	23.5	59	75	Steel Case +PCB Cape
		I (MA)	110	500	1500	15000	
260/190*10	267/187*16	V(MV)	1.1	16.5	41	53	Steel Case +PCB Cape



## Nanocrystalline Instrument Current Transformer Core

1. Bare Core Size

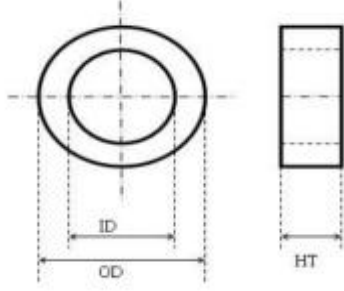

2. Finished Size (Core Cap)

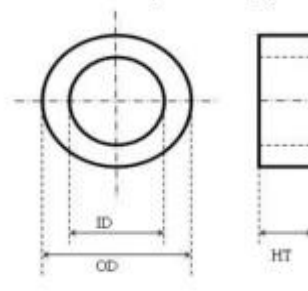

Core Size	Core Caps	Specification					Packing
		I (MA)					
265/185*40	272/178*46	I (MA)	110	500	1500	15000	Steel Case +PCB Cape
		V(MV)	5	75	187	242	
265/230*30	272/223*36	I (MA)	120	550	1650	16500	Steel Case +PCB Cape
		V(MV)	1.3	25	62	79	
285/265*10	292/258*16	I (MA)	140	600	1800	18000	Steel Case +PCB Cape
		V(MV)	0.31	4.4	11.5	15	
290/260*10	297/253*16	I (MA)	140	650	1800	18000	Steel Case +PCB Cape
		V(MV)	0.47	11.5	17.5	22.5	
	312/273*26	I (MA)	140	650	1950	18000	Steel Case +PCB Cape
		V(MV)	0.8	11.5	29.5	38	
310/245*10	317/238*16	I (MA)	140	620	1850	18000	Steel Case +PCB Cape
		V(MV)	1	15	38	49	
310/245*30	317/238*36	V(MV)	3	45	114	147	Steel Case +PCB Cape
385/363*15	392/356*21	I (MA)	180	830	2500	18000	Steel Case +PCB Cape
		V(MV)	0.53	7.5	19.5	24.8	
385/363*30	392/356*36	V(MV)	1.05	15	39	49.5	Steel Case +PCB Cape
405/325*40	413/317*46	I (MA)	180	820	2500	18000	Steel Case +PCB Cape
		V(MV)	5	72	188	242	
410/375*20	418/357*25	I (MA)	180	900	2700	18000	Steel Case +PCB Cape
		V(MV)	1.1	16	42	52.5	
420/120*50	428/115*56	I (MA)	130	600	1800	18000	Steel Case +PCB Cape
		V(MV)	24	350	880	1130	
440/363*10	448/355*16	I (MA)	200	900	2700	18000	Steel Case +PCB Cape
		V(MV)	1.2	17	45	58	
440/363*15	448/355*21	V(MV)	1.8	25.5	67.5	87	Steel Case +PCB Cape
460/363*10	468/355*16	I (MA)	200	900	2700	18000	Steel Case +PCB Cape
		V(MV)	1.5	22	56	76	
460/363*15	468/355*21	V(MV)	2.25	33	84	109.5	Steel Case +PCB Cape
460/363*10	468/355*16	I (MA)	210	950	2850	18000	Steel Case +PCB Cape
		V(MV)	2	28	72	92	
460/363*15	468/355*21	V(MV)	3	42	108	138	Steel Case +PCB Cape
510/480*10	517/473*16	I (MA)	240	1100	4650	18000	Steel Case +PCB Cape
		V(MV)	0.48	7	19	22.5	
510/480*15	517/473*21	V(MV)	0.72	10.5	29.5	>33.8;<44	Steel Case +PCB Cape
560/480*10	567/472*16	I (MA)	250	1150	3500	18000	Steel Case +PCB Cape
		V(MV)	1.25	17	47	60	
560/480*15	567/472*21	V(MV)	1.9	25.5	70.5	90	Steel Case +PCB Cape
630/480*10	638/472*16	I (MA)	270	1250	3700	18000	Steel Case +PCB Cape
		V(MV)	2.4	34.5	88	113	
630/480*15	638/472*21	V(MV)	3.6	51.8	132	169.5	Steel Case +PCB Cape
1003/838*30	1013/828*40	I (MA)	-	-	-	2500	Steel Case +DMP
		V(MV)	-	-	-	150	



### Nanocrystalline Instrument Current Transformer Core

1. Bare Core Size

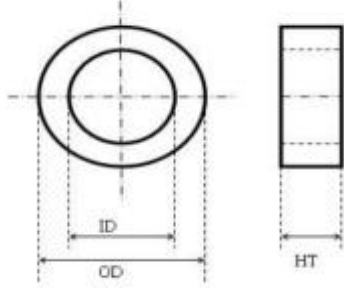

2. Finished Size (Core Cap)

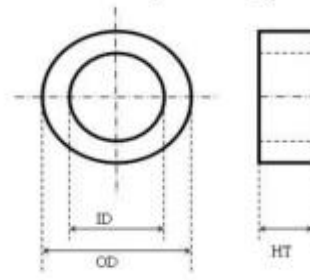

Core Size	Core Caps	Specification					Packing
		I (MA)	-	-	-	2500	
1003/838*6C 1013/828*80(40+40)		V(MV)	-	-	-	300	Steel Case +DMP

**Note:**

Core Size Limited: **Max. OD 1200mm; Min. ID 3mm; Any height is available.**